

1. Front Body (Front Body, installation on the outside of the door)

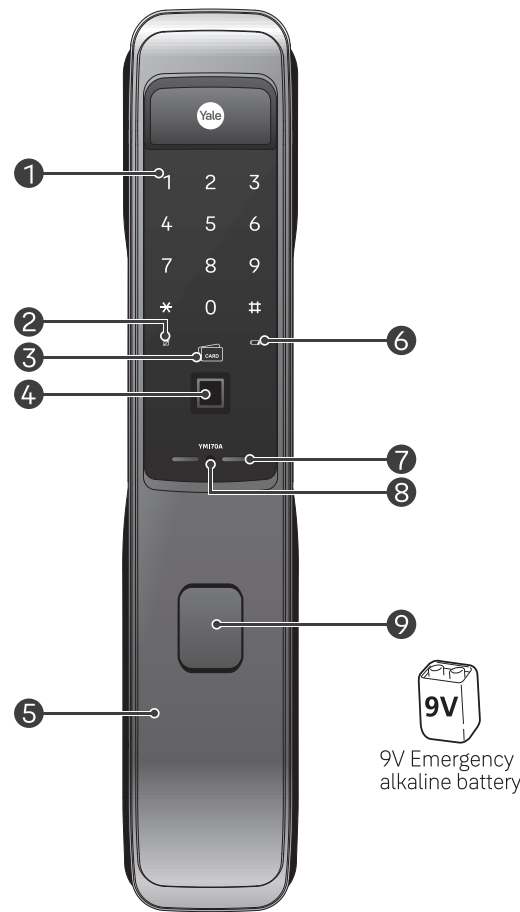

4. Main Body (Main Body, installation on the inside of the door)

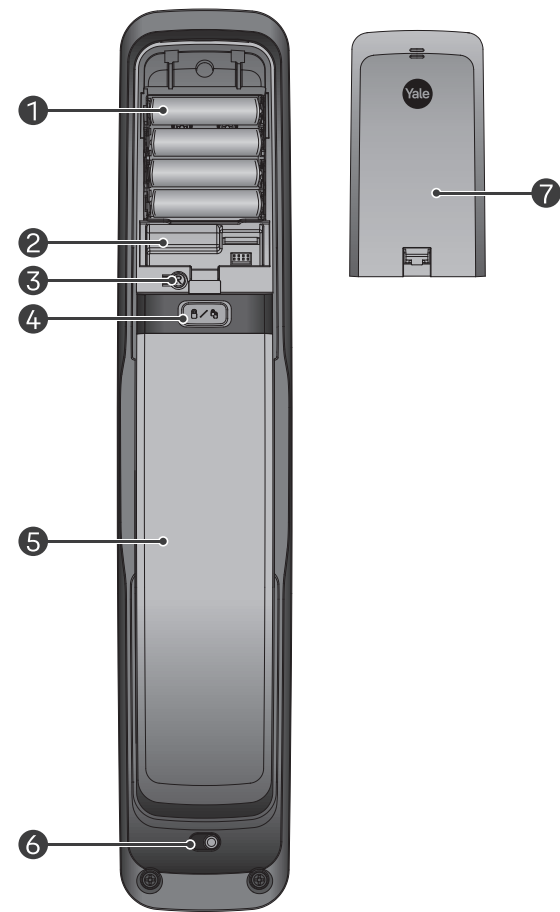

2. Basic Contents

Basic Contents

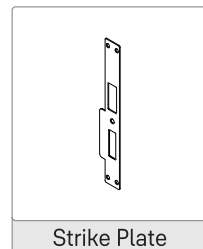
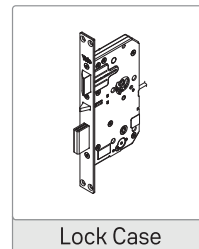
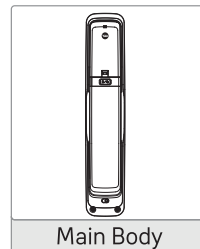
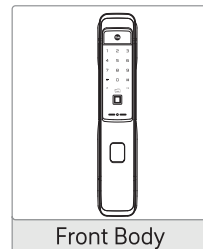

- User Manual
- Installation Guide
- AA Battery x4
- RFID Key Tags x4
- Mechanical Keys X2
- Screws

Optional Accessories

- Remote Controller
- Remote Control Module
- Bluetooth Module

3. Specifications

Parts	Specifications	Remarks
Front Body	71.4(D) X 77(W) X 397.4(H) mm	Rated Voltage : DC 6V Operating temperature : -15~55°C Sensor operating temperature(High) : 55°C
Main Body	78(D) X 77(W) X 396.7(H) mm	
Works for	4EA 1.5V AA Alkaline batteries(Available for 1 year under the assumption of 10 times use per day)	
Type of product	Direct current, Temperature Sensor, Not fire resistant, Key is not available, Deadbolt type door lock (D-F-T-NK-M).	

※ Battery life may vary depending on temperature, moisture levels, frequency of use and the quality of battery used.

7. Setting Menu

Master Mode: Only a designated person who knows 'Master PIN Code' has authority to set features.
Normal Mode: If no user is assigned with master code without a designated person, anyone who knows 'User PIN Code' has authority to set features.
Visitor Code: Users with Visitor Code can only open the door with no access to change settings.
Onetime Code: The onetime code is used only once for unlocking the door lock and automatically deleted after usage.
User Slot Number: It should be 2 digits(like '01', '02'...'99', '00') and available in advanced mode.

	Touch the Keypad of the Front Body with your palm to begin
	Press * button on the Keypad
	Press # button on the Keypad
	Press R (Registration) button in every steps to start or complete the session
	Enter User RFID Key Tag (Up to 100Users)
	Enter User Fingerprint (Up to 100Users)
	Enter User Code (4 ~ 10 digits)
	Enter Master Code (4 ~ 10 digits)
	Enter Visitor Code (Only 4 digits)
	Enter Onetime Code (Only 4 digits)
	User Slot Number should be 2 digits (like '01' ... '99' and '00'. Location of 100th user slot must be assigned '00' instead of '100'.)
	Rotation area to add more features

8. Product Features

- One Touch Fingerprint Access**
Secure one Touch Live fingerprint detection for personalized access. Unique Sensor not only provides high security but faster unlocking experience as well.
- Yale Access App**
Yale Access gives you the peace of mind of knowing who and what you love is safe - no matter where you are- just at the touch of your smartphone.
- Smart Touchpad – Auto Lock**
The door Locks when you touch the palm on the keypad.
- 3 minute Lock Out Feature**
After five (5) unsuccessful attempts of an invalid code or RFID key tag or fingerprint, lock out mode is activated for 3 minutes.
- Smart Etiquette**
When entering a pin code on the keypad, the user can open the door lock in silent mode.
- Fake PIN Code**
Security enhancement to enter any number before or after entering a password to prevent the PIN code from being exposed.
- Internal Forced Lock**
It is a security-enhancing function that 'disables' authentication methods such as passwords, RFID key tags and fingerprints from outside when setting up functions indoors.
- External Forced Lock**
It is a security-enhancing function that an alarm goes off if someone opens door from inside when setting up functions outside.
- Voice Guidance**
It guides you through the operation status on how to enable various features & settings- mode for easier and more convenient use.
- Other features and Benefits**
 - Remote Controller (Optional): This option may not be available depending on your country or local dealer.
 - Network Module/Controller (Optional): It allows door lock to connect with Home network controller.
 - Intrusion/Broken Alarm.
 - Low Battery Alarm and Emergency Power Supply.

9. Normal Mode (Default Mode)

Normal mode is for convenient mode for anyone with user code to change various settings

1	12 (Registration process)	* Continue / R Complete										
1	2	3	4	5	6	7	8	9	10	11	12	
User Code Only 1 User												
Registr-ation	R	U	R	New								
RFID Key Tag Up to 100 Users												
Registr-ation	R	U	R	New								
Fingerprint Up to 100 Users												
Registr-ation	R	*	F	R	8Times							R
Visitor Code Only 1 User												
Registr-ation	U	R	1	#	1	#	V	#	*	R		
Delete	U	R	1	#	3	#	U	#	*	R		
Onetime Code Only 1 User, Automatically deleted after use												
Registr-ation	U	R	2	#	1	#	0	#	*	R		
Delete	U	R	2	#	3	#	U	#	*	R		
Delete all credentials (Fingerprint, RFID Key Tag)												
Delete all fingerprint	U	R	3	#	1	#	U	#	*	R		
Delete all RFID key tag	U	R	3	#	2	#	U	#	*	R		
Automatic Lock												
Enable	U	R	4	#	2	#	1	#	*	R		
Disable	U	R	4	#	3	#	*	R				

10. Unlocking Door with Code

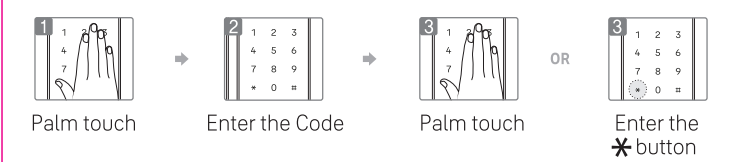

11. Unlocking Door with Fingerprint / RFID Key Tag

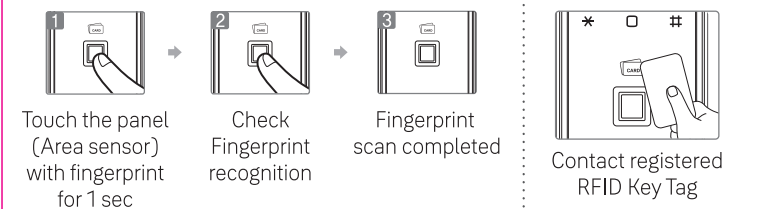

5. Front Body

- Keypad(10-key)
- Dead Bolt Jam Lamp
- RFID Key Tag reader
- Fingerprint Sensor
- Push Pull-Bar
- Low Battery Indicator
- Emergency Power Supply Terminal
- Reset Button
- Emergency Mechanical Key Slot

6. Main Body

- 1.5V AA Alkaline Batteries (4PCS)
- Module Accessory Slot (Optional)
- R Registration button
- Open/Close Button
- Push Pull Bar
- Internal Forced Lock Switch
- Battery Cover

Volume Control

High	1	#	*	R						
Low	U	R	4	#	3	#	2	#	*	R
Mute	3	#	*	R						

Language Change

Registr-ation	U	R	4	#	5	#	1	Korean	#	*	R
							2	Chinese	#	*	R
							3	English	#	*	R
							4	Taiwanese	#	*	R

Bluetooth setting (Yale Access app)

Registr-ation	U	R	7	#	Set up a new device in the app
---------------	---	---	---	---	--------------------------------

Remote Controller

Registr-ation	U	R	8	#	8	#	1	SET Button	#	*	R
Delete	U	R	8	#	3	#	U	#	*	R	

Home Network Controller

Registr-ation	U	R	9	#	1	#	Cont roller	#	*	R
Delete	U	R	9	#	3	#	U	#	*	R

Remote Controller

Set with registration button located on the top of remote controller. You can press it using a pin like the one shown in the image.

Please note following when pairing lock with Yale Access App.

- Depending on product type or FW version, app registration and door lock connection in normal mode may not be possible, so if registration is not possible, change from normal mode to master mode and try again. [App Registration in Master Mode: Master Pin Code-> R (Registration Button)-> 7 -> #]
- Because Yale Access Bluetooth App is only available in master mode, user code automatically changes to master code when registering APP in normal mode.
- Please be informed that all registered credentials will be deleted when changing mode or registering and deleting app.

12. External Forced Lock

- Enable External Forced Lock : Fingerprint**
Scan with registered fingerprint and hold the fingerprint area until you hear 3 beep sounds.
- Enable External Forced Lock : User Code**
Palm touch → Enter the User PIN Code → Enter the # button for 5 Sec.
- Enable External Forced Lock : RFID Key Tag**
Contact RFID key tag on [RFID key tag reader] for 5 sec. until you hear 3 beeps.
- Disable External Forced Lock**
When the door is unlocked from outside based upon proper authentication, the External forced lock will be released.
- Internal Forced Lock**
Close the door then move the Lock button to "LOCK" position.

13. Unlocking Door with Smart Etiquette.

